

1		2	3	4	
RevNo	Revision note		Date	Signature	Checked
02	The length was changed from 18.1mm to 21.5mm, removed a groove for end of thread		04/28/23	Teresa	Simon
03	Change the length from 4.5 mm to 3.91 mm and 0.6mm to 0.58 mm.		05/04/23	Teresa	Simon

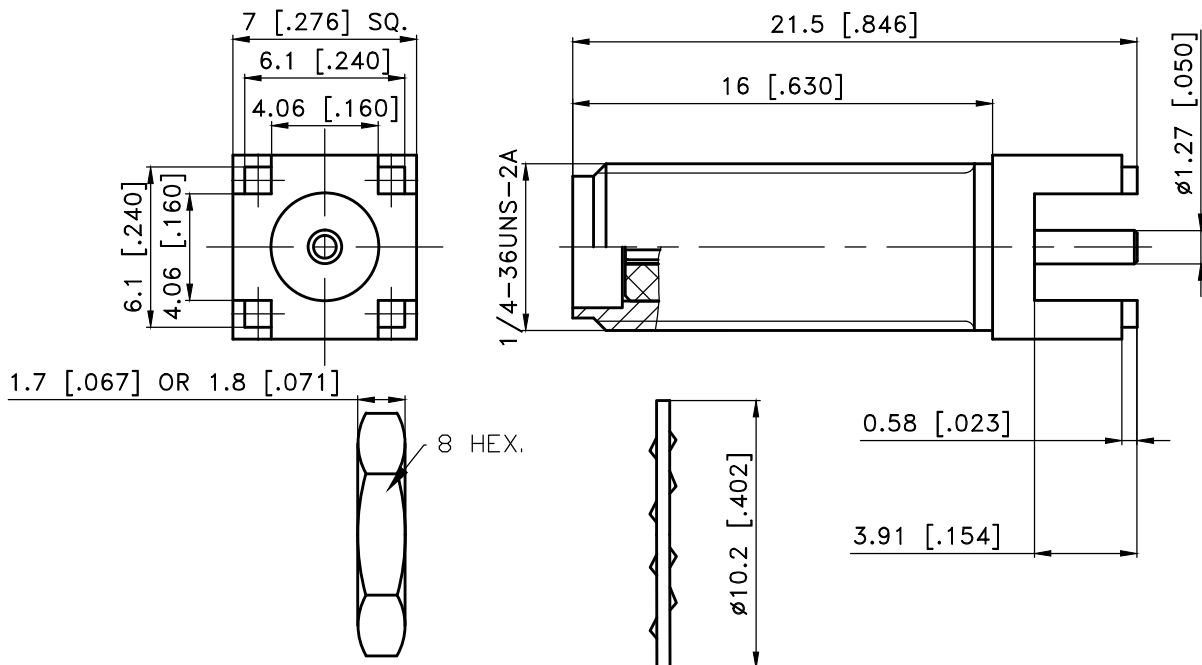

Interface Per: MIL-STD-348, IEC 60169-15

#### Material & Finishing:

- Center condutor: Beryllium Copper, Gold plating
- Insulators: PTFE
- Body & Other Material: Brass, Gold plating
- Inner tooth washer: Phosphor Bronze, Gold Plating

#### Electrical Data:

- Impedance: 50 Ohms
- Frequency Range: DC to 6 GHz
- Insulation Resistance: 5 Gohm min.
- Dielectric Withstanding Voltage: 1000 V

#### Environmental Data:

- Operating Temperature Rang: -40°C up to 125°C

ALL DIMENSIONS ARE IN MILLIMETERS AND [INCHES]

KERUI ELECTRONIC CO.,LTD.

Title

SMA-KHD-7

THESE DRAWING & SPEC. ARE THE PROPERTY OF LIJEN, LLC FROM KERUI AND SHALL NOT BE REPRODUCED, OR COPIED OR USED AS THE BASIS FOR THE MANUFACTURE OR SALE OF APPARATUS OR DEVICES WITHOUT THEIR EXPRESS WRITTEN CONSENT.

UNLESS OTHERWISE NOTED ALL SURFACES FINISHED TO 64/MAX.

ALL TOLERANCES ARE:

DECIMALS	FRACTIONS	ANGLES
x ± 1.0	±1/64	x' ± 1'
x.x ± 0.5		x'x' ± 0.5
x.xx ± 0.1		

Drawn by  
Teresa

Ckd by  
Simon

Appd by  
Richard

Date  
04/27/2023

Scale  
4:1

Sheet 1 of 1

10 1121 031 42